



Vertical Wall Anchor Instruction/Specification Manual 2025

ENGLISH
VERSION

!WARNING TO USER!

You are required to read and use the Instruction/ Specification manual supplied at the time this device was shipped. Improper use and installation can result in serious injury or death. Follow inspection requirements before each use.

Specifications

Anchor: 2" width 11ga.430sst

PPE Connector Hole: 1" dia.

Temperature Range: -30°F-120°F

Min. Breaking Strength: 5,000lb (22kN)

Max. Arrest Force: 3,600lb (16kN)

No.1004: 30° angle max. roof pitch 7/12

No.1004A: 45° angle min. roof pitch 8/12

Wall Plates: 2x4 and 2x6.

Compliance: OSHA1926.502

ANSI Z359.18-17 Type D

SAS = Super Anchor Safety.

Qualified or Competent Person

See OSHA definition.

⊗ = Inspection Points

Specified Use

Use only for wood framed vertical walls that that comply with current building codes.

Max. User wt.: 310lb w/tools and equipment.

PPE: Must comply with current ANSI, CSA or OSHA fall protection standards.

Energy Absorber (E/A): Required to use a personal E/A or an SRL with an internal or external E/A when connected to the vertical wall anchor.

Max. Free Fall: 6ft

Max. Arrest Force: 1,800lb

Framing Requirements

Install onto vertical wall top plates and trusses as shown at Figs. 3,4,5. Framing must be capable of supporting 5,000lbs or 2 times the "intended fall protection load" as specified by OSHA 1926.502(d)(15)(i)(ii).

Wall Framing: 2x4 and 2x6.

Truss Chords: Min. 2x4 bottom chord for installation.

Stick Framing: May require additional blocking engineered by a qualified or competent person*.

Fall Protection Use

Prior to use the wall must be fully sheathed as shown at Fig.6, or structurally braced to support the intended fall protection load. Bracing/framing, must be specified by a qualified or competent person*.

Attachment Bolt/Nail Specifications

Bolt thru truss bottom chord w/ 5/16" grd 8 bolt and lock nut. attach anchor nail plate to the wall top plate with 4ea 16d nails.

See Figs. 3,4,5,7,8,9. **Warning!** Use only SAS supplied fasteners. Do not substitute with fasteners supplied by others.

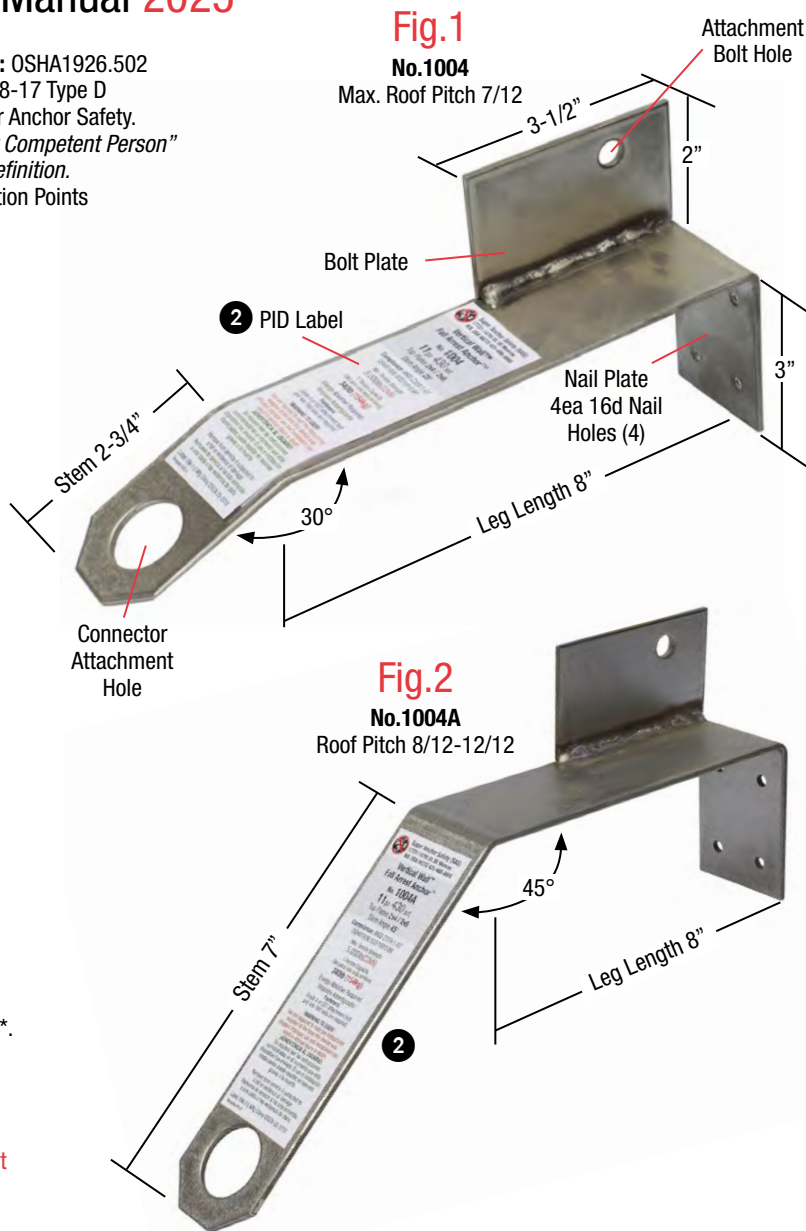

Anchor Installation/Vertical Wall Framing

Fig.3

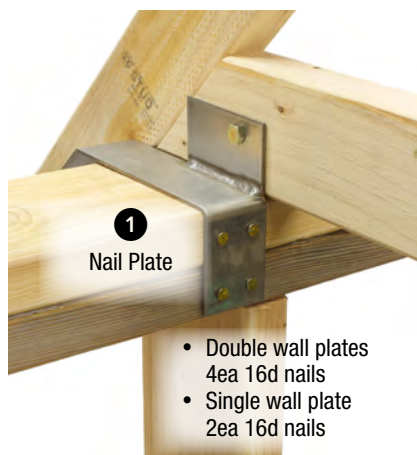

Fig.4

No.1004 w/5/12 Pitch

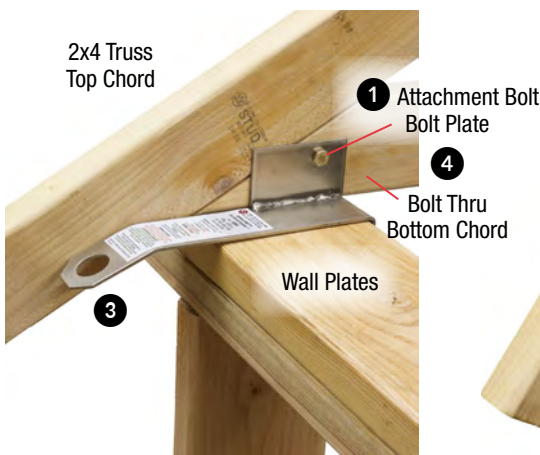
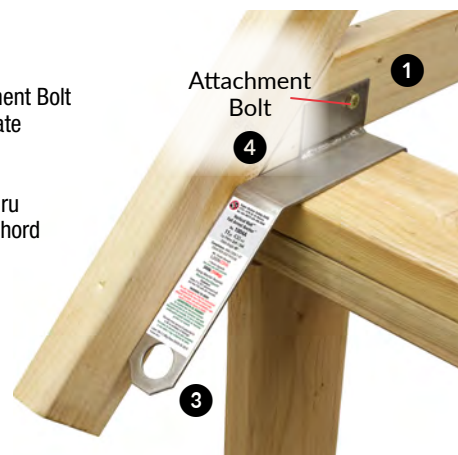

Fig.5

No.1004A w/12/12 Pitch



Fall Protection Service Zones

Project safety personnel are required to implement a job specific fall protection plan, (JSP) identifying free fall and swing fall hazards, and instructing workers not to exceed the service zone angle as shown at Fig.6.

Anchor Locations

Install onto top wall plates only spacing anchors a max. 30° angle off vertical center as shown at Fig.6. Anchor locations to be specified by a qualified or competent person* or SAS plan service.

Visual Inspection

Prior to use for fall protection, confirm the attachment bolt and nail plate nails are installed as shown at Figs. 3,4,5,8.

Attachment Bolt Installation

- 1) Secure anchor to wall top plate with 16d nails.
- 2) Drill pilot hole with a 3/8" drill bit. See Fig.7.
- 3) Bolt anchor to truss cord as shown at Fig.8.

Note: Use only SAS supplied bolt, lock nut and nails.

Fig.7

Using the bolt plate bolt hole as a template, drill a pilot hole thru the framing.

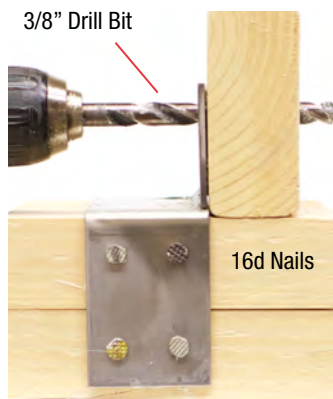
**Fig.8**

Install the 5/16" bolt with a 1/2" socket or wrench so the bolt threads extend past the lock nut face.

WARNING! Do not use an impact wrench to tighten the bolt.

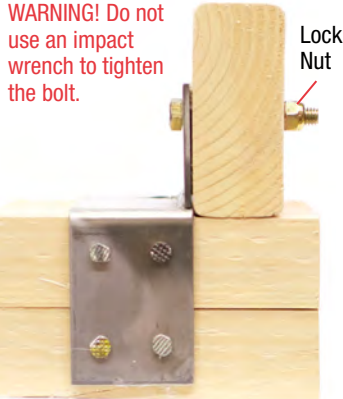
**SAS Bolt Kit No.2014**

4ea 16d Vinyl Coated Nails



Replacement bolt kits available on request.

Installation Record

Project safety personnel are required to include an inspection document in the JSP, confirming the anchor has been installed as specified by SAS and is approved for fall protection use.

Removed From Service
Dispose of anchors in a way that will prevent further use.

Modification/Repair

Do not modify, bend, drill, weld, paint or remove sections of the anchor without authorization from Super Anchor Safety.

Typical Fall Hazards:

- Leading and gable edges
- Openings in the work surface
- Objects in a swing fall path
- Levels below the work surface

Fall Protection Definitions**Fall Arrest OSHA 1910.140**

"A system used to arrest an employee in a fall from a walking-working surface."

Fall Restraint OSHA 1926.751

"A means of fall protection that prevents the user from falling any distance."

Fig.6

Service Zone Angle

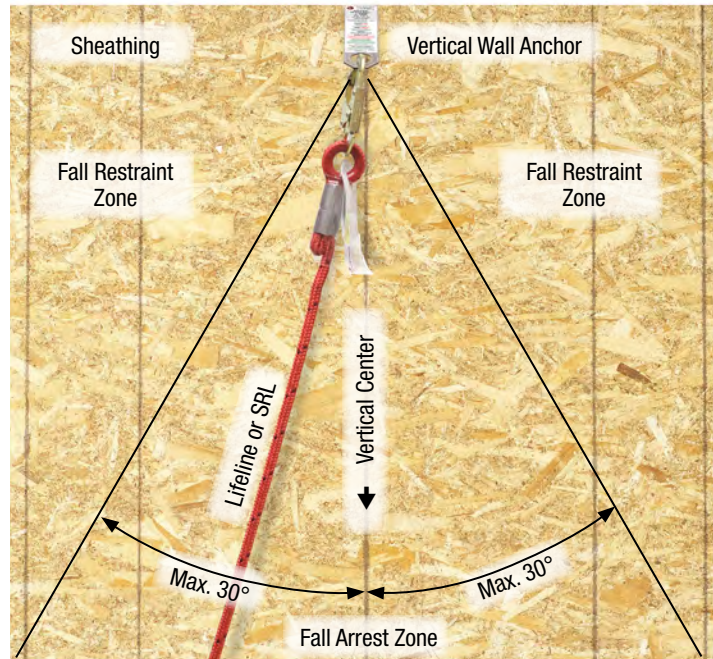

Remove anchor from service if any of the following conditions are present:

⊗ = Inspection points. ☒ = Remove from service.

☑ = Corrective action required.

- 1 Does not pass visual inspection. ☒ Figs.3,4,5. Install anchor correctly. ☑
- 2 PID label is missing. ☒ Figs.1,2. Replace anchor. ☑
- 3 Anchor stem if deformed or twisted. ☒ Figs.4,5. Replace anchor. ☑
Do not re-bend the leg, stem or nail plate.
- 4 Bolt plate/leg weld is cracked. ☒ Figs.4,5. Replace anchor. ☑
Subjected to a fall. ☒ Replace anchor. ☑

Fig.9

PID Labels

